

PROJECT AISLE
 EAST CR. 40W AND RONALD REAGAN PKWY.
 BROWNSBURG, INDIANA

LANDSCAPE PLAN

Woolbert
 333 North Alabama Street
 Suite 200
 Indianapolis, IN 46204
 DR. 317.299.7600
 CXC. 317.291.5905

PROJECT NO: 81172
 DATE: 08/03/20
 DES. DR.
 CXC.

REVISION

NO. DATE

SHEET NO. **C502**

Layout: Tab Name: C600, Images: Xrefs: 81172BLK.dwg
 Lant: Saved By: hock, 8/7/2020 4:14:58 PM
 C:\Users\Walter\OneDrive\Documents\81172BLK.dwg
 Project: Brownsburg Project - Adult Facility - 4.0 Discipline: Civil\Road\81172BLK.dwg
 Plotted By: Cdempster, Brooks Plotted: 8/11/2021 11:52:29 AM

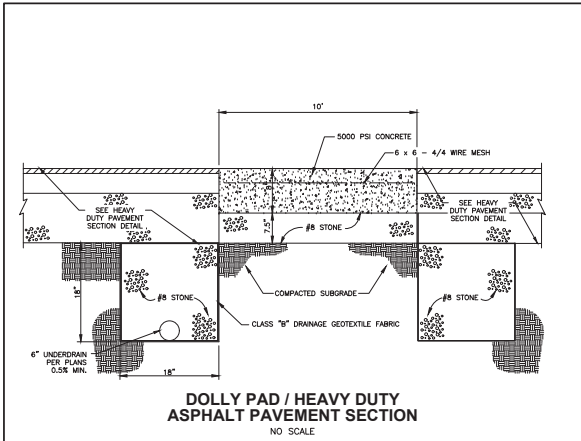

DOLLY PAD / HEAVY DUTY ASPHALT PAVEMENT SECTION
NO SCALE

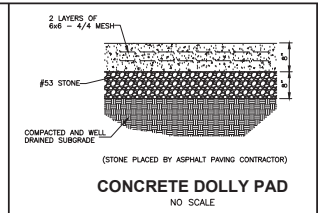

CONCRETE DOLLY PAD
NO SCALE

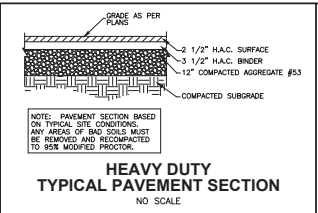

HEAVY DUTY TYPICAL PAVEMENT SECTION
NO SCALE

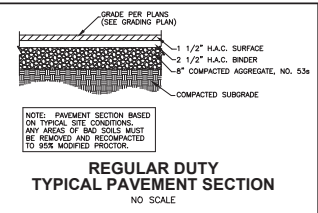

REGULAR DUTY TYPICAL PAVEMENT SECTION
NO SCALE

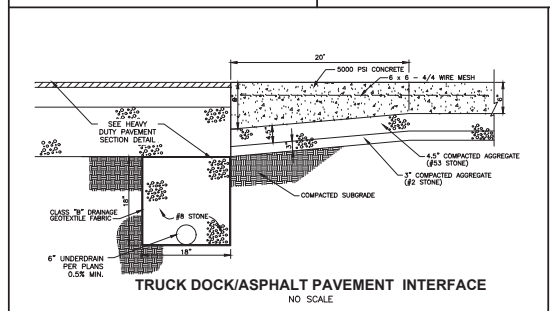

TRUCK DOCK/ASPHALT PAVEMENT INTERFACE
NO SCALE

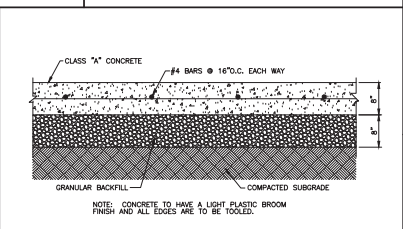

REINFORCED CONCRETE PAVEMENT
NO SCALE

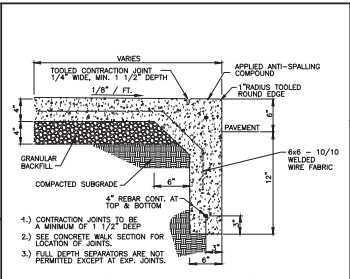

INTEGRAL WALK AND CURB
NO SCALE

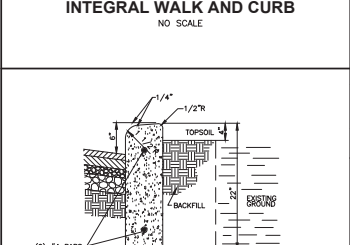

6" STRAIGHT CURB
NO SCALE

NOTES:
 1) CONTRACTION JOINTS SHALL BE PLACED EVERY 20' MAX. TO A DEPTH OF 1 1/2".
 2) FULL DEPTH SEPARATORS ARE NOT PERMITTED EXCEPT AT EXPANSION JOINTS.
 3) EXPANSION JOINTS TO BE PLACED @ 100' MAXIMUM.

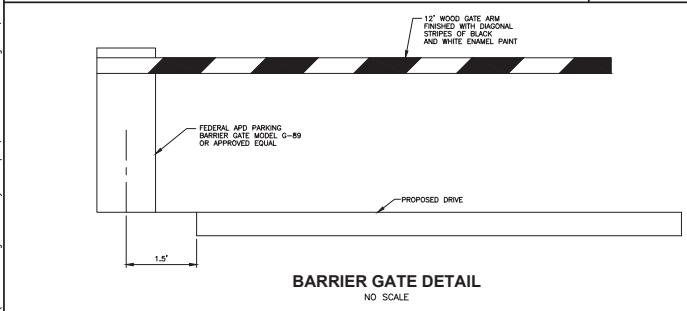

BARRIER GATE DETAIL
NO SCALE

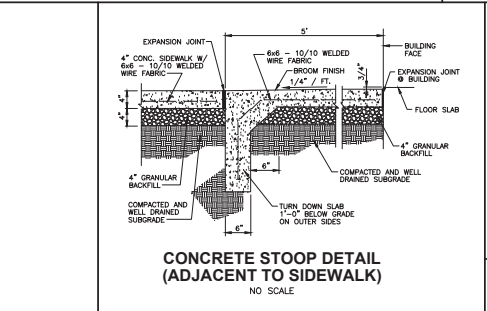

CONCRETE STOOP DETAIL (ADJACENT TO SIDEWALK)
NO SCALE

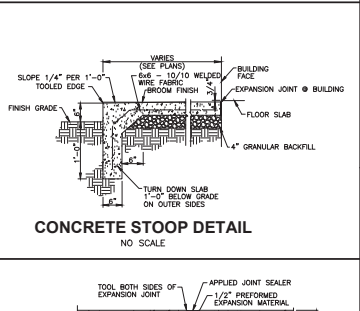

CONCRETE STOOP DETAIL
NO SCALE

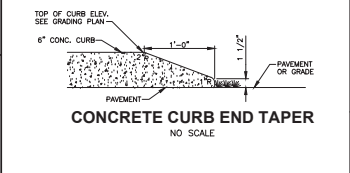

CONCRETE CURB END TAPER
NO SCALE

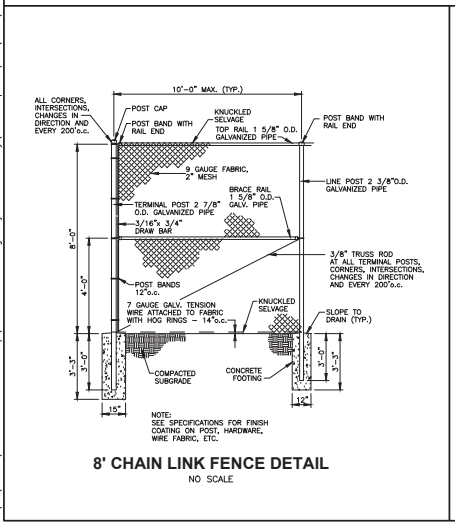

8" CHAIN LINK FENCE DETAIL
NO SCALE

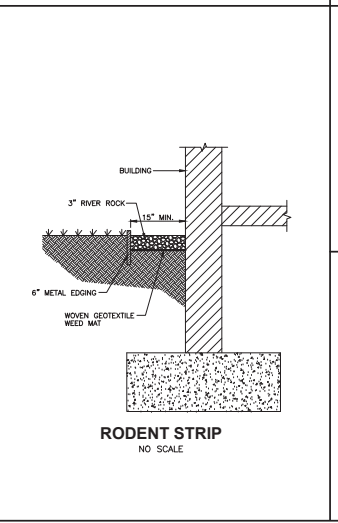

RODENT STRIP
NO SCALE

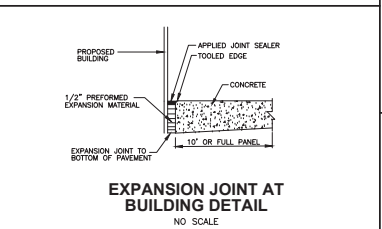

EXPANSION JOINT AT BUILDING DETAIL
NO SCALE

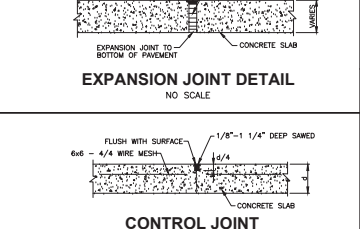

EXPANSION JOINT DETAIL
NO SCALE

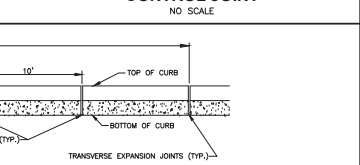

CONTROL JOINT
NO SCALE

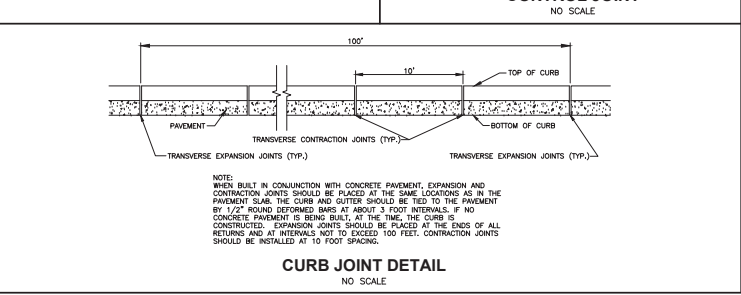

CURB JOINT DETAIL
NO SCALE

NOTE:
 WHEN BUILT IN CONJUNCTION WITH CONCRETE PAVEMENT, EXPANSION AND CONTRACTION JOINTS SHOULD BE PLACED AT THE SAME LOCATIONS AS IN THE PAVEMENT SLAB. THE CURB AND OUTER SHOULD BE TIED TO THE PAVEMENT BY 1/2" ROUND DEFORMED BARS OF ABOUT 3 FOOT INTERVALS. IF NO CONCRETE PAVEMENT IS BEING BUILT, AT THE TIME, THE CURB IS CONSTRUCTED. EXPANSION JOINTS SHOULD BE PLACED AT THE ENDS OF ALL RETURNS AND AT INTERVALS NOT TO EXCEED 100 FEET. CONTRACTION JOINTS SHOULD BE INSTALLED AT 10 FOOT SPACING.

REVISION	DATE	NO.	PROJECT NO.	DATE	DES.	DR.	CKD.
			81172	08/03/20			
			333 North Alabama Street				
			Suite 200				
			Indianapolis, IN 46204				
			317.297.7600				
			BROWNSBURG, INDIANA				
			FAX: 317.291.5805				
			WOOLBERT				
			PROJECT AISLE				
			EAST CR. 40W AND RONALD REAGAN PKWY.				
			BROWNSBURG, INDIANA				
			DETAILS				
			SHEET NO.				
			C600				

Project: 81172BLK.dwg
 User: Samed Byrchock, 8/2/2020 4:14:59 PM
 Path: C:\Users\jwerner\OneDrive\Documents\Projects\81172BLK.dwg
 Project: 81172BLK.dwg
 User: Samed Byrchock, 8/2/2020 4:14:59 PM
 Path: C:\Users\jwerner\OneDrive\Documents\Projects\81172BLK.dwg

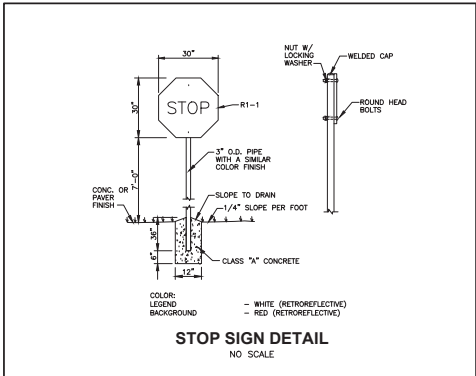

STOP SIGN DETAIL
NO SCALE

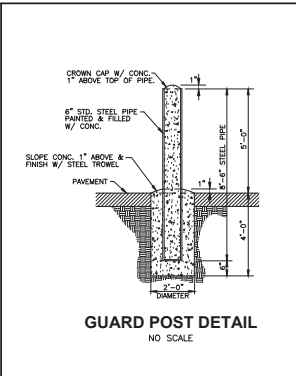

GUARD POST DETAIL
NO SCALE

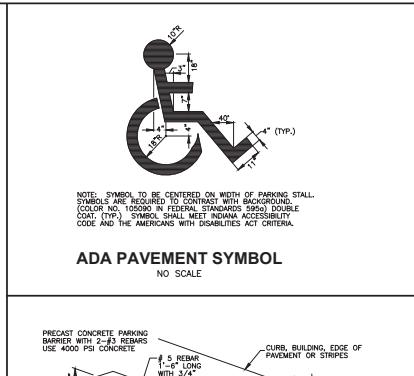

ADA PAVEMENT SYMBOL
NO SCALE

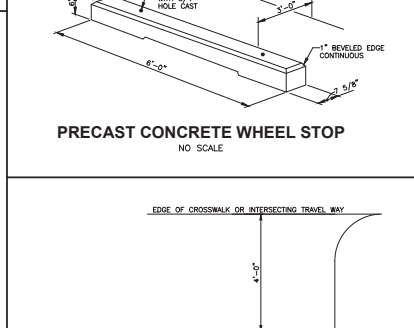

PRECAST CONCRETE WHEEL STOP
NO SCALE

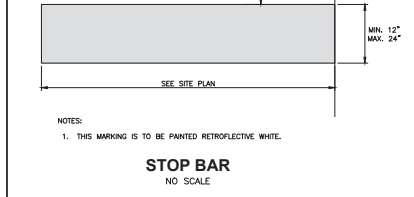

STOP BAR
NO SCALE

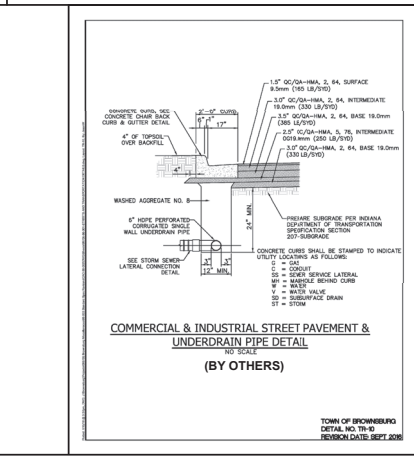

COMMERCIAL & INDUSTRIAL STREET PAVEMENT & UNDERDRAIN PIPE DETAIL
(BY OTHERS)

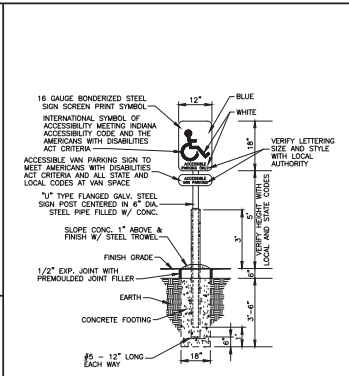

ADA PARKING SIGN
NO SCALE

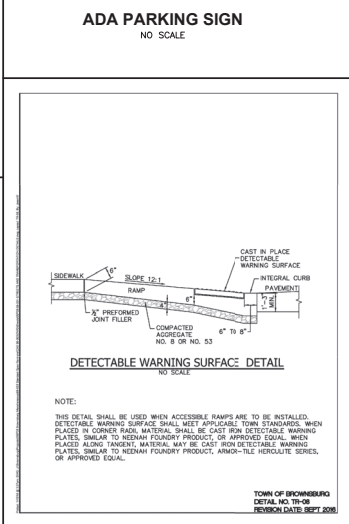

DETECTABLE WARNING SURFACE DETAIL
NO SCALE

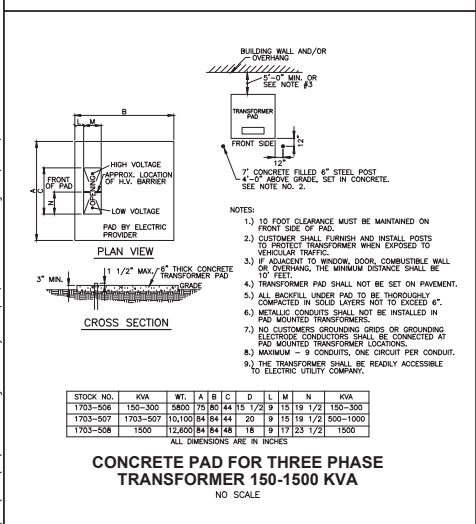

CONCRETE PAD FOR THREE PHASE TRANSFORMER 150-1500 KVA
NO SCALE

STOCK NO.	KVA	WT.	A	B	C	D	L	M	N	KVA		
1703-508	150-300	5800	75	80	44	15	1/2	9	15	19	1/2	150-300
1703-507	1703-507	10,100	84	84	44	20	9	15	19	1/2	500-1000	
1703-508	1500	12,200	84	84	44	18	9	17	23	1/2	1500	

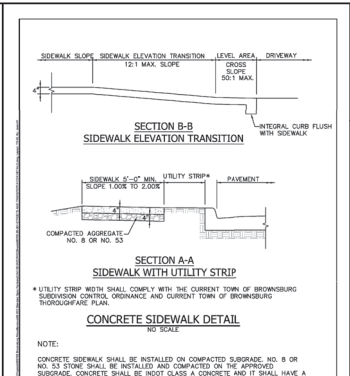

SECTION B-B SIDEWALK ELEVATION TRANSITION
NO SCALE

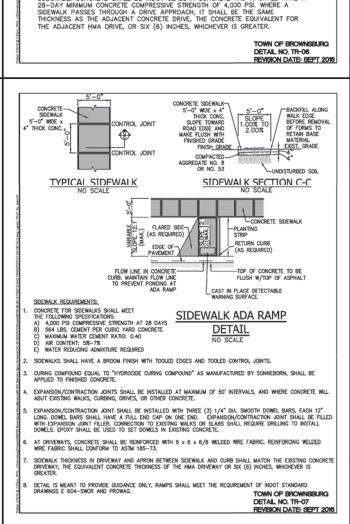

SECTION A-A SIDEWALK WITH UTILITY STRIP
NO SCALE

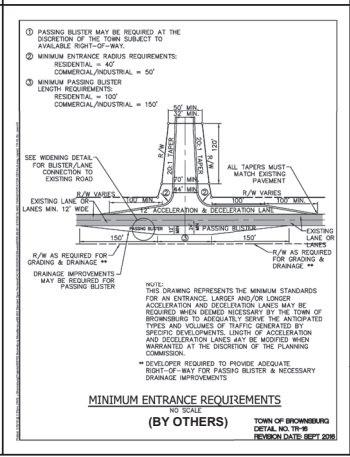

MINIMUM ENTRANCE REQUIREMENTS
(BY OTHERS)

REVISION	DATE	PROJECT NO.	DATE	DES.	DR.	CHECKED
		81172	05/03/20			

333 North Alabama Street
 Suite 200
 Indianapolis, IN 46204
 317.299.7600
 317.291.5805

WOLBERT
 ENGINEERS & ARCHITECTS

PROJECT AISLE
 EAST CR. 40W AND RONALD REAGAN PKWY.
 BROWNSBURG, INDIANA

DETAILS
 SHEET NO. **C601**

Layout Tab Name: C602; Xrefs: 811721BLK.dwg
 Last Saved By: hchoch, 8/2/2020 4:14:59 PM
 C:\EPC\Utility\Planer\Construction\Group\081712 Brownsburg Project\Aisle Facility\4.0 Discipline\Civil\Coord\CA\81172DET.dwg Plotted: By: celermay, 8/3, 2020, 4:28:53 PM

PIPE UNDERDRAIN AT STRUCTURES (TYPICAL INSTALLATIONS)

NO SCALE

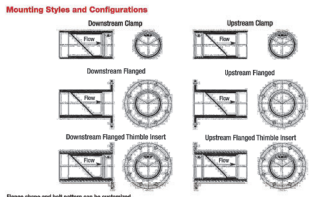
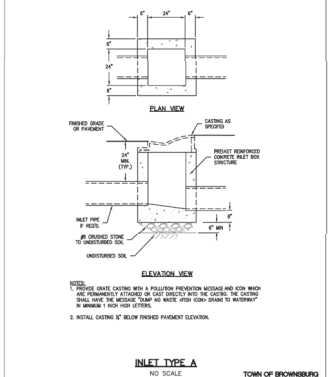
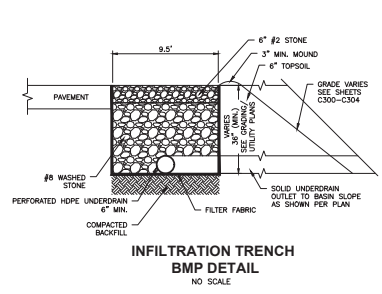
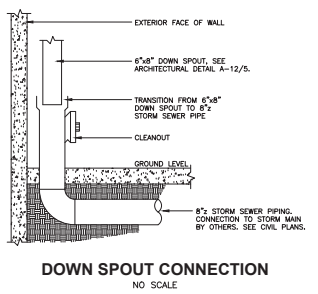
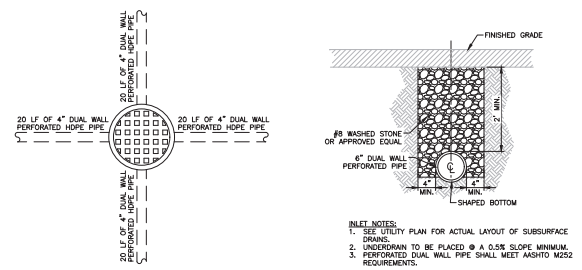

NOMINAL PIPE SIZE (D.A.) Inches	NOMINAL PIPE SIZE (D.A.) Millimeters	OVERALL LENGTH** Inches	NUMBER OF CLAMPS	HOFF DEPTH		BACK PRESSURE RATING		
				Inches	Millimeters	Feet	Millimeters	
				1	2	3	4	
4	100	7.88	500	1.5	38	40	12	
6	150	11.81	729	1	2	51	40	12
7	178	16.25	987	1	2	51	40	12
9	225	18.29	987	1	2	51	40	12
10	255	21.21	1044	1	2	51	40	12
12	300	23	1044	1	2	51	40	12
14	350	25.76	1054	1	2	51	40	12
16	400	28.61	727	1	4	102	20	6
18	450	31	787	1	4	102	20	6
20	500	42.34	1076	2	6	203	20	6
24	600	47.8	1027	2	6	203	20	6
28	700	49.37	1386	2	8	203	20	6
36	900	62.25	1981	2	8	203	20	6
42	1050	72	2087	2	8	203	13	4
54	1350	86.32	2766	2	8	203	13	4
60	1500	102.5	2824	2	12	203	13	4
72	1800	118	3022	2	12	203	16	5

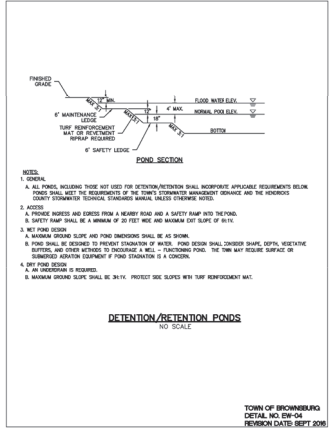

TIDEFLEX IN-LINE CHECK VALVE

NO SCALE

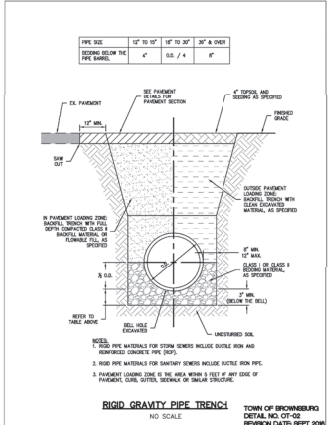
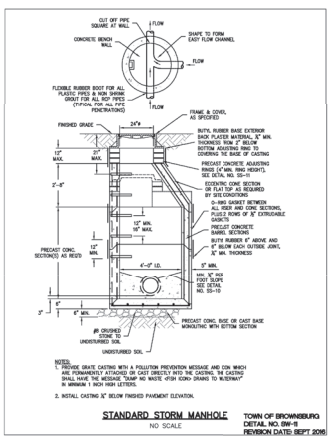
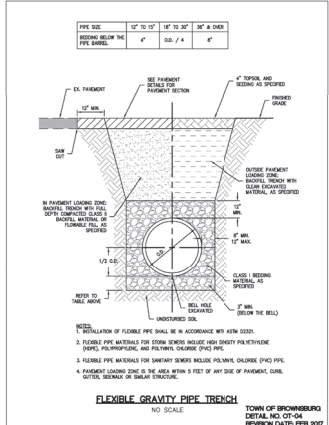
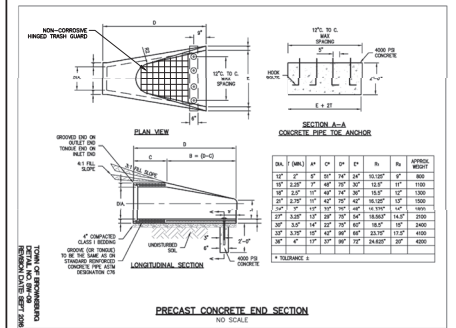

NO.	DATE	REVISION

PROJECT NO:	81172
DATE:	05/03/20
DES.:	
DR.	
CAD.	

333 North Alabama Street Suite 200 Indianapolis, IN 46204 317.299.7600 FAX: 317.291.5605
WOLBERT
INDUSTRIAL CONTRACTORS

PROJECT AISLE	
EAST C.R. 40W AND RONALD REAGAN PKWY. BROWNSBURG, INDIANA	
DETAILS	

SHEET NO. **C602**

Layout Tab Name: C603_Images - Xrefs: 81172BLK.dwg
 Last Saved By: hchock, 8/2/2020 4:14:58 PM
 C:\E:\Clients\Wagner Construction Group\08172_Brownburg Project\Aish Facility\A-0 Disciplines\Civil\Code\81172DET.dwg Plotted By: cadman, 8/2/2020 4:30:16 PM

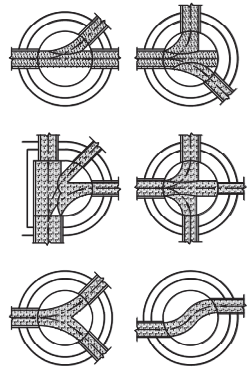

**SANITARY SEWER
 BENCH SLOPE = 1/2" PER FOOT
 TROUGH WIDTH = PIPE DIAMETER x 1.3
 STANDARD MANHOLE BENCHES
 NOT TO SCALE**

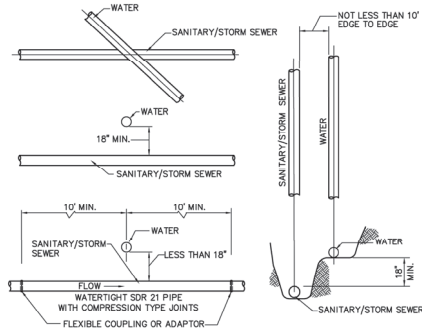

NOTES:

1. WHEN LATERAL SEPARATION IS 10' OR GREATER NO VERTICAL CLEARANCE IS NEEDED.
2. ALL CROSSINGS AND SEPARATIONS TO BE 327 IAC, ARTICLES 3 & 8
3. WHEN HORIZONTAL SEPARATION IS LESS THAN 10' OR VERTICAL SEPARATION IS LESS THAN 18", SANITARY PIPE MUST BE WATERTIGHT SDR 21 WITH COMPRESSION TYPE JOINTS.
4. CONTRACTOR SHALL VERIFY THAT MORE STRINGENT SEPARATION REQUIREMENTS DO NOT EXIST WITH THE JURISDICTIONAL WATER UTILITY. IF THEY DO EXIST, CONTRACTOR SHALL FOLLOW THE MORE STRINGENT REQUIREMENTS.

**MIN. CROSSOVER & SEPARATION REQUIREMENTS FOR
 WATER & SANITARY/STORM SEWERS
 NOT TO SCALE**

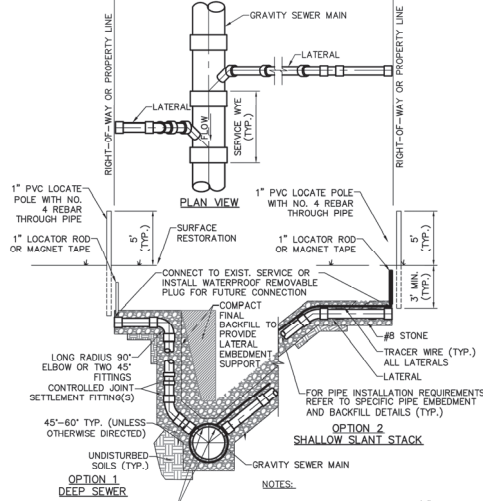

CONTRACTOR SHALL PROVIDE "AS-BUILT" SERVICE CONNECTION TIES TO THE OWNER, ENGINEER, AND PROPERTY OWNER (TYP.)

**TYPICAL SERVICE CONNECTION
 NOT TO SCALE**

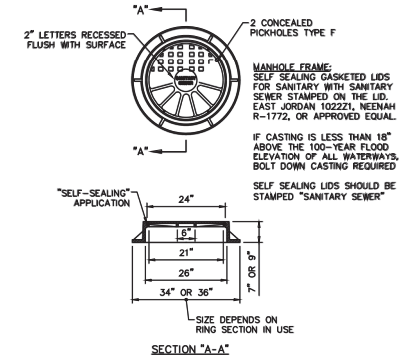

**SANITARY SEWER MANHOLE
 FRAME AND COVER
 NOT TO SCALE**

- NOTES:**
1. NORMAL LATERAL SLOPE IS 1/4" PER FOOT MINIMUM LATERAL SLOPE IS 1/8" PER FOOT
 2. MINIMUM COVER IS 3 FEET OVER PIPE
 3. ADDITIONAL CLEANOUT REQUIRED AT RIGHT-OF-WAY WHERE LATERAL CROSSES ROADWAY.
 4. MINIMUM LATERAL SIZE IS 6".
 5. WITH SEWER UTILITY APPROVAL, DEEP SEWER SLANT STACK MAY BE INSTALLED.

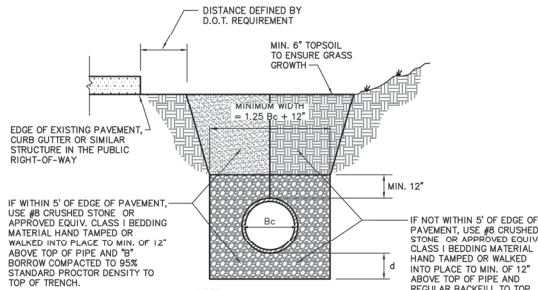

**PLASTIC PIPE (PVC & HDPE) BEDDING DETAIL
 NOT TO SCALE**

EDGE OF EXISTING PAVEMENT, CURB GUTTER OR SIMILAR STRUCTURE IN THE PUBLIC RIGHT-OF-WAY

IF WITHIN 5' OF EDGE OF PAVEMENT, USE #8 CRUSHED STONE OR APPROVED EQUIV. CLASS II BEDDING MATERIAL HAND TAMPED OR WALKED INTO PLACE TO MIN. OF 12" ABOVE TOP OF PIPE AND "B" BORROW COMPACTED TO 95% STANDARD PROCTOR DENSITY TO TOP OF TRENCH.

NOTE:
 ALL INITIAL BACKFILL SHALL BE INSTALLED IN 6" TO 12" BALANCED LIFTS.
 A MINIMUM 9" OF CLEARANCE SHALL BE PROVIDED ON EACH SIDE OF THE INSTALLED PIPE.

LEGEND
 Bc= OUTSIDE DIAMETER
 D= INSIDE DIAMETER
 d= DEPTH OF BEDDING MATERIAL BELOW PIPE

DEPTH OF BEDDING MATERIAL BELOW PIPE	
D	d (MIN)
27" & SMALLER	4
30" TO 60"	4
66" & LARGER	4

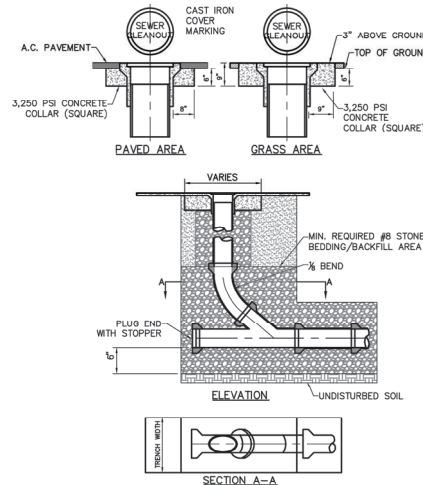

- NOTES:**
1. CLEANOUT PIPE TO BE SAME SIZE AND KIND OF MATERIAL AS MAIN
 2. INSTALL SEWUR VALVE BY KODIAK CONTROLS, INC., OR APPROVED EQUAL.

**SEWER CLEANOUT
 NOT TO SCALE**

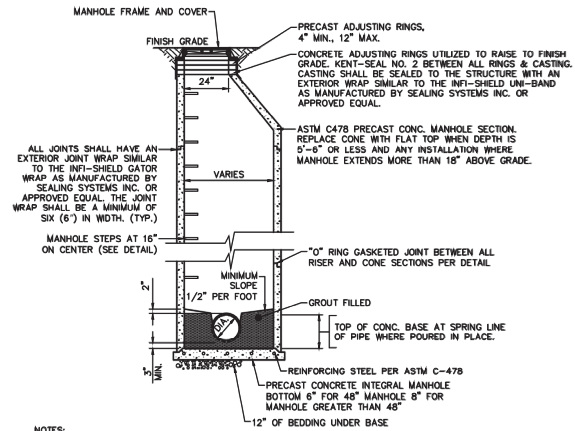

NOTES:

1. MANHOLE SHALL CONFORM TO ASTM C-478.
2. JOINTS SHALL CONFORM TO ASTM C-433.
3. PIPE CONNECTIONS TO MANHOLES SHALL BE MADE WITH WATERTIGHT FLEXIBLE RUBBER BOOTS WITH STAINLESS STEEL BANDS OR FLEXIBLE WATERTIGHT GASKETS. ACCEPTABLE PRODUCTS ARE: KOP-N-SEAL AS MANUFACTURED BY CORE AND SEAL COMPANY; DURA-SEAL III AS MANUFACTURED BY DURA TECH, INC.; PSX AS MANUFACTURED BY THE PRESS SEAL GASKET CORPORATION, OR APPROVED EQUAL. PIPE SEAL SHALL MEET ASTM C-443.
4. PIPE OPENINGS IN BASE AND RISER SECTIONS SHALL BE FORMED OR CORE-DRILLED.

**STANDARD PRECAST CONCRETE MANHOLE
 (FOR PIPE SIZES 8" TO 24")
 NOT TO SCALE**

NO.	DATE	REVISION

PROJECT No: 81172
 DATE 08/03/20
 DES. DR. CXC
 333 North Alabama Street
 Suite 200
 Indianapolis, IN 46204
 317.293.7600
 FAX: 317.291.5605



PROJECT AISLE
 EAST CR. 40W AND RONALD REAGAN PKWY.
 BROWNINGSBURG, INDIANA

DETAILS

SHEET No.
C603

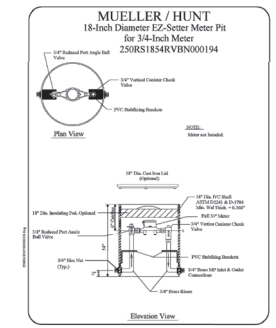

MUELLER / HUNT
18-inch Diameter EZ-Setter Meter Pit
for 3/4-inch Meter
250RS184SRVBN00194
TOWN OF BROWNSBURG
DETAIL NO. DW-08
REVISION DATE: SEPT. 2007

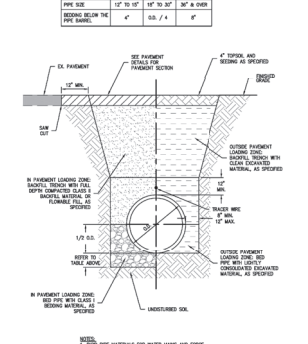

RIGID PRESSURE PIPE TRENCH
NO SCALE
TOWN OF BROWNSBURG
DETAIL NO. DW-08
REVISION DATE: SEPT. 2007

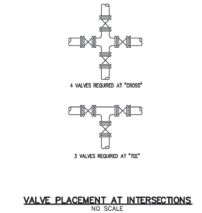

VALVE PLACEMENT AT INTERSECTIONS
NO SCALE
TOWN OF BROWNSBURG
DETAIL NO. DW-08
REVISION DATE: SEPT. 2007

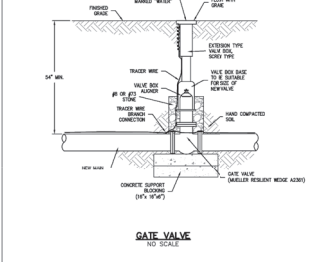

GATE VALVE
NO SCALE
TOWN OF BROWNSBURG
DETAIL NO. DW-02
REVISION DATE: SEPT. 2007

ENDOT INDUSTRIES
PIPE AND TUBING

EndoPure PE-4710
High-Density Polyethylene (HDPE) Pipe & Tubing

BLUE WATER SERVICE PIPE (BWP) - 100' CONTROLLED - A-TM DODS

SIZE	WALL	WT	WT PER FOOT	DRINKING WATER	INDUSTRIAL	SEWER
1/2"	3.1	0.5	0.016	300	300	300
3/4"	3.9	0.6	0.018	300	300	300
1"	4.7	0.7	0.021	300	300	300
1 1/4"	6.3	0.9	0.027	300	300	300
1 1/2"	7.1	1.0	0.030	300	300	300
2"	9.7	1.3	0.040	300	300	300
2 1/2"	12.3	1.6	0.050	300	300	300
3"	14.9	2.0	0.060	300	300	300
3 1/2"	17.5	2.4	0.070	300	300	300
4"	20.1	2.8	0.080	300	300	300
4 1/2"	22.7	3.2	0.090	300	300	300
5"	25.3	3.6	0.100	300	300	300
5 1/2"	27.9	4.0	0.110	300	300	300
6"	30.5	4.4	0.120	300	300	300
6 1/2"	33.1	4.8	0.130	300	300	300
7"	35.7	5.2	0.140	300	300	300
7 1/2"	38.3	5.6	0.150	300	300	300
8"	40.9	6.0	0.160	300	300	300
8 1/2"	43.5	6.4	0.170	300	300	300
9"	46.1	6.8	0.180	300	300	300
9 1/2"	48.7	7.2	0.190	300	300	300
10"	51.3	7.6	0.200	300	300	300
10 1/2"	53.9	8.0	0.210	300	300	300
11"	56.5	8.4	0.220	300	300	300
11 1/2"	59.1	8.8	0.230	300	300	300
12"	61.7	9.2	0.240	300	300	300
12 1/2"	64.3	9.6	0.250	300	300	300
13"	66.9	10.0	0.260	300	300	300
13 1/2"	69.5	10.4	0.270	300	300	300
14"	72.1	10.8	0.280	300	300	300
14 1/2"	74.7	11.2	0.290	300	300	300
15"	77.3	11.6	0.300	300	300	300

ENDOT SERVICE LINE SPECIFICATIONS
NO SCALE
TOWN OF BROWNSBURG
DETAIL NO. DW-08
REVISION DATE: SEPT. 2007

**TABLE 1: DI PIPE RESTRAINT FOR BEHIND CURB PAVEMENT LOADING ZONE
FEET OF RESTRAINED PIPE @ 150 PSI**

FITTING TYPE	WATER MAIN SIZE				
	4 INCH	6 INCH	8 INCH	10 INCH	12 INCH
1 1/2\" BEND	37'	29'	25'	22'	20'
25\" BEND	37'	29'	25'	22'	20'
45\" BEND	37'	29'	25'	22'	20'
90\" BEND	37'	29'	25'	22'	20'
120\" VERTICAL BEND	37'	29'	25'	22'	20'
180\" VERTICAL BEND	37'	29'	25'	22'	20'
MUCK/SLURRY	37'	29'	25'	22'	20'
TEE W/STAY	37'	29'	25'	22'	20'

**TABLE 2: DI PIPE RESTRAINT FOR BEHIND INSIDE PAVEMENT LOADING ZONE
FEET OF RESTRAINED PIPE @ 150 PSI**

FITTING TYPE	WATER MAIN SIZE				
	4 INCH	6 INCH	8 INCH	10 INCH	12 INCH
1 1/2\" BEND	37'	29'	25'	22'	20'
25\" BEND	37'	29'	25'	22'	20'
45\" BEND	37'	29'	25'	22'	20'
90\" BEND	37'	29'	25'	22'	20'
120\" VERTICAL BEND	37'	29'	25'	22'	20'
180\" VERTICAL BEND	37'	29'	25'	22'	20'
MUCK/SLURRY	37'	29'	25'	22'	20'
TEE W/STAY	37'	29'	25'	22'	20'

INSTALLATION SPECIFICATIONS FOR WATER TAPS AND METER SETS
NO SCALE
TOWN OF BROWNSBURG
DETAIL NO. DW-08
REVISION DATE: SEPT. 2007

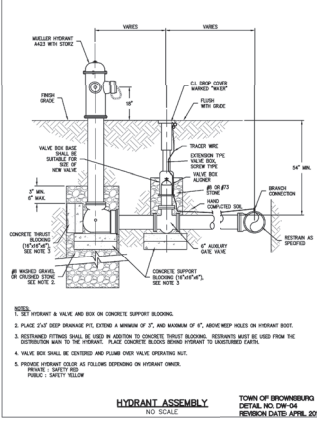

HYDRANT ASSEMBLY
NO SCALE
TOWN OF BROWNSBURG
DETAIL NO. DW-04
REVISION DATE: APRIL 2007

ENDOT INDUSTRIES
PIPE AND TUBING

EndoPure
The Standard in Polyethylene Pipe and Tubing

ENDOT SERVICE LINE SPECIFICATIONS
NO SCALE
TOWN OF BROWNSBURG
DETAIL NO. DW-08
REVISION DATE: SEPT. 2007

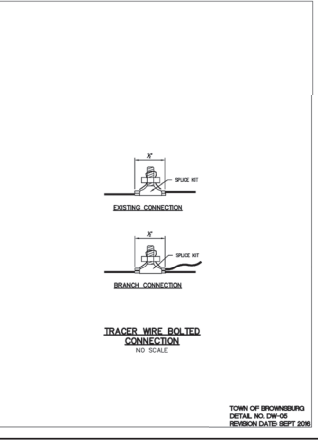

TRACER WIRE BOLTED CONNECTION
NO SCALE
TOWN OF BROWNSBURG
DETAIL NO. DW-08
REVISION DATE: SEPT. 2007

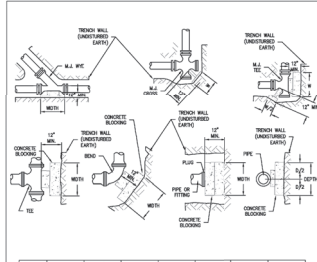

WATER MAIN REACTION BLOCKING
NO SCALE
TOWN OF BROWNSBURG
DETAIL NO. DW-08
REVISION DATE: APRIL 2007

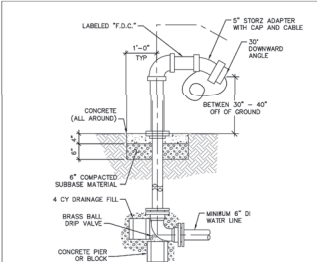

FIRE DEPARTMENT CONNECTION DETAIL
NO SCALE
TOWN OF BROWNSBURG
DETAIL NO. DW-08
REVISION DATE: APRIL 2007

NO.	DATE	REVISION

PROJECT NO.: 81172
DATE: 05/03/20
DES.: DR.
C.D.R. DR.
C.D.C. DR.

333 North Alabama Street
Suite 200
Indianapolis, IN 46204
DR. WOODLERT
BROWNSBURG, INDIANA
FAX: 317.291.5805

PROJECT AISLE
EAST CR. 400W AND RONALD REAGAN PKWY.
BROWNSBURG, INDIANA

SHEET NO.
C604

STORM STRUCTURE TABLE				
STRUCTURE ID	DESCRIPTION	RIM/GRATE	INVERTS	CASTING
AS-10	See Detail	865.49	21" = 861.77 (SW) 21" = 861.77 (NW)	---
AS-13	See Detail	868.32	30" = 859.18 (SW) 30" = 859.18 (NW)	---
1.0	End Section	860.25	24" = 857.50 (NW)	---
1.1	End Section	860.60	24" = 857.85 (SE)	---
1.10	Storm Manhole, 60" Dia.	868.67	36" = 859.19 (S) 36" = 859.19 (N) 30" = 859.19 (NE)	NEENH R-1772
1.11	Storm Manhole, 60" Dia.	866.13	36" = 860.11 (S) 36" = 860.11 (N)	NEENH R-4342
1.12a	Storm Manhole, 60" Dia.	866.13	36" = 860.45 (S) 36" = 860.45 (N)	NEENH R-4342
1.12b	Storm Manhole, 60" Dia.	866.13	36" = 860.79 (S) 36" = 860.79 (N)	NEENH R-4342
1.13	Storm Manhole, 60" Dia.	866.13	36" = 861.12 (E) 36" = 861.50 (W)	NEENH R-3405
1.14	Inlet, Type A	866.30	30" = 861.50 (S) 30" = 861.50 (N)	NEENH R-3405
1.15	Inlet, Type A	866.97	30" = 861.67 (S) 30" = 861.67 (N)	NEENH R-3405
1.16	Inlet, Type A	866.97	30" = 861.84 (N) 30" = 861.84 (S)	NEENH R-3405
1.17	Inlet, Type A	866.97	24" = 862.01 (S) 30" = 862.01 (N) 12" = 862.82 (E)	NEENH R-3405
1.18	Inlet, Type A	866.97	24" = 862.18 (N)	NEENH R-3405
1.19	Storm Manhole, 60" Dia.	866.62	12" = 863.32 (W)	NEENH R-4342
1.2	End Section	862.77	48" = 857.85 (N)	---
1.3	End Section	863.12	48" = 858.20 (S)	---
1.4	End Section	863.40	21" = 858.48 (W)	---
1.5	Storm Manhole, 60" Dia.	865.49	21" = 858.75 (NW) 21" = 858.75 (E)	NEENH R-1772
1.6	Storm Manhole, 60" Dia.	864.94	21" = 859.08 (NW) 21" = 859.08 (SE)	NEENH R-1772
1.7	End Section	864.20	21" = 859.28 (SE)	---
1.8	End Section	862.83	36" = 859.00 (S)	---
1.9	Storm Manhole, 60" Dia.	867.95	36" = 859.16 (S) 36" = 859.16 (N) 30" = 859.17 (SE)	NEENH R-1772
2.0	End Section	863.24	24" = 860.49 (SW)	---
2.1	Storm Manhole, 60" Dia.	863.95	24" = 860.57 (W) 24" = 860.57 (NE)	NEENH R-1772
2.2	End Section	863.69	24" = 860.94 (E)	---
2.3	End Section	866.00	24" = 863.25 (W)	---
2.4	End Section	866.10	24" = 863.35 (E)	---
3.0	End Section	865.52	36" = 861.68 (S)	---
3.1	Storm Manhole, 60" Dia.	865.08	36" = 861.74 (S) 36" = 861.73 (N) 21" = 861.76 (SE)	NEENH R-1772
3.2	Storm Manhole, 60" Dia.	865.74	36" = 861.78 (S) 36" = 861.78 (N) 21" = 861.78 (NE)	NEENH R-1772
3.3	Storm Manhole, 60" Dia.	868.23	36" = 861.92 (S) 36" = 861.92 (N)	NEENH R-1772
3.4	Storm Manhole, 60" Dia.	869.55	36" = 863.56 (E) 36" = 863.56 (N)	NEENH R-1772
3.5	Storm Manhole, 60" Dia.	868.92	36" = 863.72 (S) 36" = 863.72 (W)	NEENH R-1772
3.6	Storm Manhole, 60" Dia.	869.49	36" = 864.10 (N)	NEENH R-1772
4.0	Storm Manhole, 60" Dia.	868.34	36" = 860.00 (S) 36" = 860.00 (N) 24" = 860.38 (E)	NEENH R-1772
4.1	Storm Manhole, 60" Dia.	865.76	24" = 860.87 (W) 24" = 860.87 (E)	NEENH R-4342
4.2	Storm Manhole, 60" Dia.	865.80	24" = 861.50 (W)	NEENH R-4342

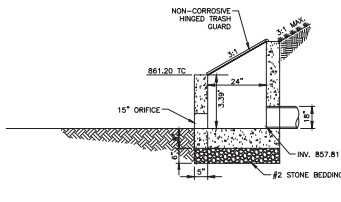
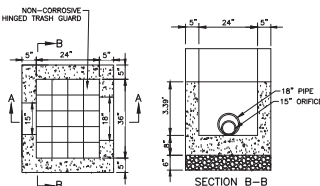

EXTENDED DRY DETENTION POND OUTLET CONTROL STRUCTURE DETAIL (STRUCTURE 1.1)

EMERGENCY OVERTFLOW WEIR SECTION
NO SCALE

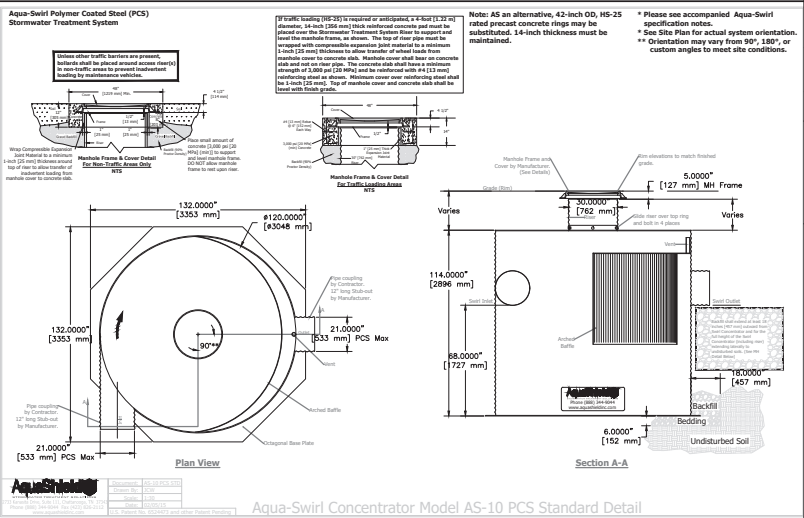
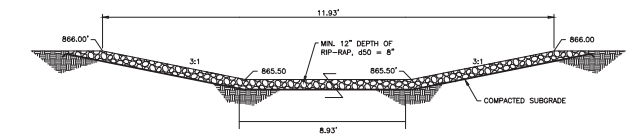

Aqua-Swirl Concentrator Model AS-10 PCS Standard Detail

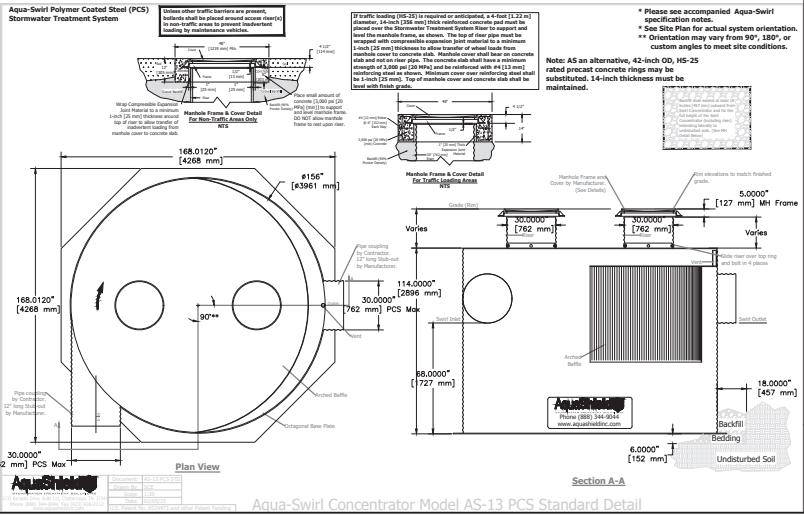

Aqua-Swirl Concentrator Model AS-13 PCS Standard Detail

REVISION	DATE	No.	PROJECT No.: 81172
			DATE: 08/03/20
			DES: DR.
			DR: DR.
			CMD: C.D.O.
PROJECT AISE			
333 North Alabama Street Suite 200 Indianapolis, IN 46204 317.299.7600 FAX: 317.291.5605			
PROJECT AISE			
EAST CR. 40W AND RONALD REAGAN PKWY. BROWNSBURG, INDIANA			
SHEET NO. C605			